

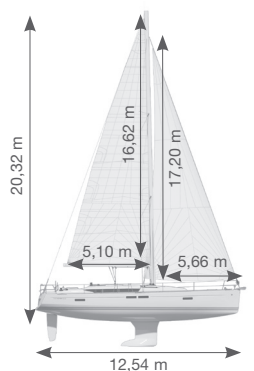

Sun Odyssey 479

SPECIFICATIONS

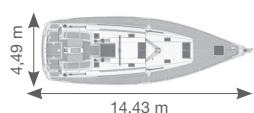

Overall length	14,05 m / 46'1"
Overall Length with Bowsprit	14,43 m / 47'4"
Hull length	13,65 m / 44'9"
Waterline length	12,54 m / 41'1"
Beam	4,49 m / 14'8"
Displacement light load with deep draft keel	10809 kg / 23830 lbs
Standard keel draft	2,24 m / 7'4"
Standard keel weight	3095 kg / 6823 lbs
Shoal keel draft	1,65 m / 5'4"
Shoal keel weight	3440 kg / 7584 lbs

CE category	A10 / B11 / C14
Fuel capacity	240 L / 63 US gal
Water capacity	640 L / 169 US gal
Fridge capacity	255 L / 67 US gal
Holding tank capacity	160 L / 42 US gal
Architect/Designer	Philippe Briand / Jeanneau Design
Furling mainsail horizontally-cut in high-quality dacron	39,3 m ² / 423 Sq ft
Standard headsail 106% horizontally-cut in high-quality dacron	42,8 m ² / 460 Sq ft

AN EXCEPTIONAL LEVEL OF EQUIPMENT

EXTERIOR

Sailing features

- High aspect ratio rig
- Harken genoa tracks
- Harken winches
- Harken deck hardware
- Aluminium furling mast and boom
- Standing rigging discontinuous stainless steel wire
- Sheets lead back to the helm – German sheeting

Construction

- Hull solid, hand-laid fibreglass, ISO gelcoat surface, protective barrier coat
- Structure 3rd generation inner fibreglass grid, high-load zones cut out and relaminated, drainage system through structure, special emergency repair zone in keel area
- Deck Prisma Process® injected deck, ISO gelcoat surface, discontinuous balsa block coring – 30% weight savings as compared to traditional decks

Cockpit

- One-level cockpit with dedicated sail handling areas

- Multi-function cockpit table
- Leather-covered steering wheels
- Telescopic swim ladder
- Hinged companionway doors

Deck

- Flush deck hatches
- Long acrylic deck windows with GRP eyebrow
- Inboard shrouds for easier access forward
- 6 mooring cleats
- Electric windlass

INTERIOR

- One-level interior with no door sills
- Leather-wrapped handrails
- Direct and indirect LED lighting
- Large, double berths
- Fully-upholstered hull sides and ceiling
- Numerous choices of interior decor
- Large storage spaces, seaworthy with fiddles

Chart table

- Large nav desk with leatherette lining and interior storage for a portable computer

Galley

- Corian® countertops
- Double stainless steel sinks
- 2-burner stove with oven
- Fridge 175 L / 46 US gal + icebox 80 L / 21 US gal with top access to better maintain the cold air

Woodwork

- Woodwork in alpi® Teak
- UV stabilised varnish
- Light oak laminate floorboards
- Numerous solid wood mouldings

TECHNICAL

Electrical

- LED navigation lights
- 12V electrical panel
- Battery Exide Dual Marine
- 125A alternator and charge distributor/isolator
- 220V shorepower
- Positive and negative battery cut-off switches to better protect battery banks

Water systems

- Hot and cold cockpit shower
- Hot water heater 40 L / 11 US gal
- "Heavy-duty" water pump

Engine

- Latest-generation Common Rail engine with reduced emissions and consumption
- Sail Drive
- Fixed 3-blade propeller
- Sound insulation 40 mm / 1 1/2" thick

TRIM LEVELS AND PACKAGES

TRIM LEVEL	PREMIERE	PREFERENCE
12V freezer unit for 80 L / 21 US gal icebox	✓	✓
3 burner cooker and oven with grill function (replaces standard 2 burner cooker)	✓	✓
2 additional opening ports in the cockpit	✓	✓
DVD/CD/MP3 player with AUX input, 2 Bose® surround sound speakers in the saloon	✓	✓
1 Bose® base unit and 2 waterproof exterior speakers located in the cockpit	✓	✓
2 x 40 amp battery chargers for 12V battery banks	✓	✓
Additional house bank batteries 2 X 115 A/H	✓	✓
Large aft fold-down swim platform with telescopic ladder	✓	✓
Curtain set for windows, ports and hatches insect screens for hatches	✓	✓
GRP bowsprit with integrated anchor roller	✓	✓
Separate shower compartment with plexiglass door	✓	✓
Vertical access door to fridge compartment		✓
1 Harken 46.2 Electric winch on the coachroof for halyards and control lines		✓
12v in place of standard winch to port		✓
Vertical fridge door		✓

NAVIGATION PACK

- Windex 15"
- Halyard bags in the cockpit
- Ball-bearing genoa lead cars and control lines lead to cockpit
- Harken 46.2 self tailing winch on starboard coachroof
- Spinnaker deck fittings with Spinlock jammers

PERFORMANCE PACK

- Flex-o-fold 3-blade, folding propeller
- Dyneema® low-stretch halyards and sheets for main and genoa
- Dyform discontinuous standing rigging

EQUIPMENT

ARCHITECTURE

- Hull chine for improved stability and speed
- Long waterline for better speed while sailing and under power
- L-shaped cast iron keel less exposed to seaweed and lines
- High ballast-to-weight ratio
- Balanced rudder with composite shaft

SAILS

Standard

- Horizontally-cut in high-quality Dacron
- In mast furling horizontally-cut in high-quality dacron 39,3 m² / 423 Sq ft
- Furling Genoa 106% with UV protection 42,8 m² / 460 Sq ft

Options

- Performance genoa 106% with UV protection in triradial cut mylar/taffeta 42,8 m² / 460 Sq ft
- Self-tacking jib with UV protection in triradial cut mylar/taffeta laminate 38,40 m² / 413 Sq ft
- Performance, full-batten mainsail in triradial cut mylar/taffeta 49,10 m² / 528 Sq ft
- Code 0 in triradial cut mylar/aramid laminate 77,4 m² / 833 Sq ft, with continuous line furler

SAIL HANDLING

Standard

- Harken genoa tracks with adjustable lead cars
- Spinlock jammers
- Coachroof winch 1 x Harken 46.2 ST to port
- Genoa winches 2 x Harken 50.2 self-tailing winches for easy use at the helm stations
- Winch handles 2 x Harken handle with ball-bearing grip

Options

- Self tacking jib ball bearing track on coachroof
- Mainsheet traveller roof-mounted traveller with ball-bearing cars, control lines lead aft to cockpit

MAST AND RIGGING

Standard

- Furling mast aluminium with double spreaders, deck-stepped
- Aluminium boom with rigid vang
- Single backstay
- Genoa furler with double slot, furling line lead aft to cockpit
- Running rigging topping lift, mainsail halyard, genoa halyard, mainsheet, genoa sheets in polyester
- Standing rigging discontinuous 1x19 stainless steel wire

Options

- Classic mast aluminium with double spreaders, deck-stepped with lazy bag and jacks
- Backstay with hydraulic adjuster
- Running rigging for asymmetrical spinnaker / code 0 includes: 2 sheets, 1 halyard, 1 downhaul, turning blocks for mast base and sidedecks

COCKPIT

Standard

- Large cockpit table with storage compartment, icebox
- Teak inlay on bench seats
- Cockpit lockers 2 under bench seats, 2 large lockers under helm stations and 1 central locker designed to hold the optional generator
- Gas locker for 2 gas bottles, cut-off valve under stove
- Wheels with a leather wrap, space for flush mounted GPS at each helm, stainless steel handrail
- Emergency tiller fitting in cockpit floor
- Engine control throttle lever and engine panel located at starboard helm
- Hinged companionway doors in plexiglass
- Sliding horizontal hatch in plexiglass

Options

- Teak inlay on cockpit floor
- Black, composite steering wheels
- Steering wheel covers Sunbrella® Taupe with zips for easy removal
- Cockpit sprayhood wide Sunbrella® Taupe with vinyl windscreen with zip-out middle window for ventilation, retractable
- Cockpit bimini Sunbrella® Taupe with stainless steel bows and integrated LED strip lighting, retractable with storage cover
- Cockpit cushions Sunbrella® Sling Taupe with back rests

DECK HARDWARE

Standard

- Bow pulpit stainless steel
- Stern pulpits stainless steel with buoy bracket and emergency ladder
- Lifelines double level of stainless steel lifelines
- Toerail in PVC
- Mooring cleats: 6 x aluminium
- Stainless steel handrails on coachroof
- Deep anchor locker
- Vertical electric windlass 1000W - 10 mm chain
- Fixed windows along coachroof
- GRP eyebrows above windows
- Large, fixed hull ports (8)
- Opening ports in cockpit and roof 4 (+2 opt.)
- Opening deck hatches (11)

Options

- Windlass control second windlass control mounted in cockpit with chain counter
- Teak decks
- Wood rubrail for hull protection
- Mooring kit 6 fenders and 4 docklines
- Anchoring kit Delta anchor 20 kg / 44 lbs, 32 m (104') of 10 mm chain and 45 m (147') of 18 mm line
- Lifeline gates

SAIL LOCKER

Standard

- Access via lockable deck hatch
- Access ladder in stainless steel

LIGHTING

Standard

- Direct LED lighting in saloon and cabins

Options

- Indirect LED strip lighting (not available for all layouts)

ELECTRICAL

Standard

- Main electrical panel at navigation station 12V plug, LCD display
- 12V circuit for house and engine systems, 12V plugs and 220V plugs in each cabin, saloon, chart table and galley
- Domestic battery bank capacity: 3 x 115 A/H 12V
- Engine start battery capacity: 1 x 120 A/H 12V
- 12 v alternator output: 125A
- Positive battery switch for engine and domestic bank and general cut-off switch

Options

- Inverter 2000 W 12v/220v
- Generator ONAN 6Kw 220V 2400RPM its sound shield and located in a sound-shielded compartment in the transom, access via water-tight hatch
- Solar panel on coachroof with charging relay
- Upgrade of domestic bank to lithium batteries

PLUMBING

Standard

FRESH WATER

- "Heavy-duty" water pump (19 L / 5 US gal/mn), accumulator tank for consistent water pressure
- 2 roto moulded tanks: 400 L / 106 US gal, under forward cabin berth and 240 L / 63 US gal, under aft berth
- Tank manifold with selector valves
- Tank gauges located at the electrical panel
- 40 L / 11 US gal hot water tank that is connected to engine heat exchanger and 220V system
- Hot and cold cockpit shower on transom

GREY AND BLACK WATER

- Large manual pump marine toilets
- 2 x 80 L / 21 US gal holding tanks with gravity drain and deck fitting

GREY AND BLACK WATER

- Electric bilge pump located in bilge area with activation via switch at electrical panel
- Electric bilge pump located in the forward sail locker, with activation via float switch, with separate hose from primary bilge pump
- Dual-action manual bilge pump located in the cockpit, with separate hose from primary bilge pump

GAS

- Gas detector

Option

- Electric Quiet-Flush toilets in place of standard, available for each head compartment

ENGINE

Standard

- Latest-generation Common Rail engine with reduced emissions and consumption
- Engine Yanmar 4JH57CR Sail-Drive - 57 HP / 41Kw - Alternator 125A
- Engine panel and throttle located near starboard helm
- Insulation: foam 40 mm / 1 ½", with fire-retardant film
- Built-in muffler, air ventilation and stainless steel exhaust fitting
- Fixed 3-blade propeller
- Ventilation system extractor fan located in engine room
- Roto moulded fuel tank (240 L / 63 US gal) located under aft cabin berth, fuel/water separator
- Access behind steps to engine compartment

Options

- Engine Yanmar 4JH80CR Sail-Drive - 80 HP / 59Kw - Alternator 125A
- Extra diesel storage tank 240 L / 63 US gal in lieu of one water tank
- Bow thruster 24V with separate 24V OPTIMA REDTOP

LAYOUTS



Version A
Forward cabin, 2 aft cabins,
2 head compartments

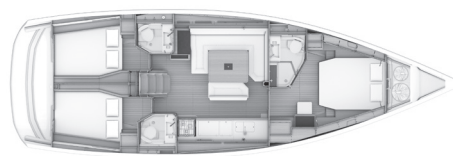

Version B
Forward cabin, 2 aft cabins,
3 head compartments

INTERIOR

Woodwork

- Alpi® Teak interior laminated panels with solid wood trim around galley, companionway and cabinetry, finished in satin UV stabilised varnish
- Fully-upholstered hull sides and ceiling
- Light oak laminate floorboards

Options

- Dark Oak laminate floorboards
- Woodwork in Alpi® Light Oak with mouldings in solid Alpi® Oak, UV stabilised varnish

Saloon

- Comfortable seating arrangement to port for 6 with view of sea through hull ports
- Hinged storage compartments under settee seating
- Large table with two removable, aluminium legs and central bottle storage

Options

- Folding de luxe table in main saloon with bar and storage drawers in the fixed base
- Convertible berth in saloon with infill cushion for saloon table
- Central two-seat bench with storage (version B)

Chart Table

- Chart table with leatherette worktop with opening compartment, space designed for laptop computer
- Large storage space under electrical panel for books and other navigation equipment (version A)
- Convertible navigation station located to starboard (version A)
- Navigation station located to port behind the saloon (version B)
- Chart reading light with red night-time vision mode
- 2 armchairs to starboard (version A)

Galley

- Corian® countertops
- Double stainless steel sinks with covers and chrome fixtures
- Soft-close, fully-extending drawers
- Sliding waste bins with multiple compartments for selective sorting and recycling
- Upper storage cabinets with storage and space for optional microwave (option)
- 2 Burner stove and oven with protective handrail
- Fridge 175 L / 46 US gal + icebox 80 L / 21 US gal with top access to better maintain the cold air
- Opening port above stovetop for ventilation
- Long galley to starboard of entryway (version B)
- Large, L-shaped galley to starboard of entryway (version A)

Comfort

- Cushions in high-density foam
- Premium mattresses

Options

- TV antenna for masthead with amplifier
- 22" LED TV mounted at nav station, pivots to be visible from settee and latches when underway
- Surround-sound system
- Cruisair® air conditioning 32000 BTU runs via shorepower or generator with 3 units
- Microwave installed in galley
- Webasto diesel forced air heating 5500W (version A)
- Eberspacher® circulating water heating system 12,000W with outlets in all cabins and toilets (version B)

Forward owner's cabin

- Extra wide cabin door for easy access (56 cm / 1'10")
- Double berth with high-density foam mattress 203 cm x 160 cm / 6'8" x 5'2"
- Large hanging locker to starboard
- Additional hanging locker to port
- Night tables with leatherette lining
- An office/vanity area with leatherette desktop, mirror and storage area with light
- Full-length mirror
- LED reading lights and overhead led lighting
- Handrail with leather wrap
- Opening deck hatches, for light and ventilation
- 2 large fixed hull ports

- 2 large storage drawers under berth + storage under berth with top access
- Washrooms: solid surface countertop and moulded sink, storage cabinets, deck hatch to provide light and ventilation, LED overhead lighting and task lighting, standing shower separated by a plexiglass door (option), shower drain with switch, marine toilet with manual pump, clothes hook and towel bar, mirror

Options

- Mattress battens for owner's cabin berth

Double aft cabins

- Double berth with high-density foam mattress 205 cm x 144 cm / 6'8" x 4'8"
- Hanging locker storage shelf along hull, night stand above engine compartment, storage shelf along engine compartment
- LED overhead lighting and reading light
- 1 fixed hull port, 1 opening port into the cockpit for ventilation
- 1 window in coachroof
- 1 deck hatch
- Access to tanks and technical equipment in central corridor
- Washrooms: en-suite compartment with access from cabin: en-suite compartments with day access from saloon, solid surface countertop with moulded sink, access to through-hulls and plumbing connections under sink, storage cabinets, opening port and fixed windows to provide light and ventilation, LED overhead lighting and task lighting, shower drain with switch, marine toilet with manual pump, clothes hook and towel bar, hanging bar, mirror

Option

- LED lighting along berth

HEADROOM

Forward cabin(s)	1,93 m / 6'3"	Saloon	1,94/1,97 m / 6'4" / 6'3"
Aft cabins	1,97 m / 6'5"	Galley	1,93 m / 6'3"
Companionway	1,97 m / 6'5"		



JEANNEAU

