

Sun Fast  
3200



## S U M M A R Y

- > SPECIFICATIONS
- > KEY POINTS
- > EXTERIOR
- > INTERIOR
- > RESULTS
- > CONSTRUCTION
- > ELECTRONIC PACKAGES



JEANNEAU



## TECHNICAL INFORMATION

Overall length: ..... 10,10 m / 33' 1"  
 Hull length: ..... 9,78 m / 32'  
 Waterline length: ..... 8,55 m / 28'  
 Beam: ..... 3,48 m / 11' 5"

Displacement: ..... 3.400 kg / 7.496 lbs  
 Standard keel draft: ..... 1,90 m / 6' 2"

Cabins: ..... 2  
 Berths: ..... 6

Engine power: ..... Yanmar 15 Hp / 11 Kw  
 Fuel capacity: ..... 75 l / 20 US gal  
 Water capacity: ..... 80 l / 21 US gal  
 Cold capacity: ..... 60 l / 16 US gal

Sail area:  
 - Standard ..... 60 m<sup>2</sup> / 645 Sq ft

CE Category: ..... A6

Designer: ..... Andrieu Yacht Design

## > KEY POINTS

- Exceptional speed: modern hull designed by Daniel Andrieu. Twin rudders, lead keel, wide and light hull.
- Advanced technologies: infusion moulded hull, deck and main bulkhead to optimise weight and increase strength.
- Practical comfort: galley, chart table, twin double aft cabins and a head compartment are designed for cruising or racing;
- All-around performance: perfectly adaptable to one design racing, solo, double-handed or team racing around the buoys or offshore.
- Elected European Yacht of the Year 2008



## DECK

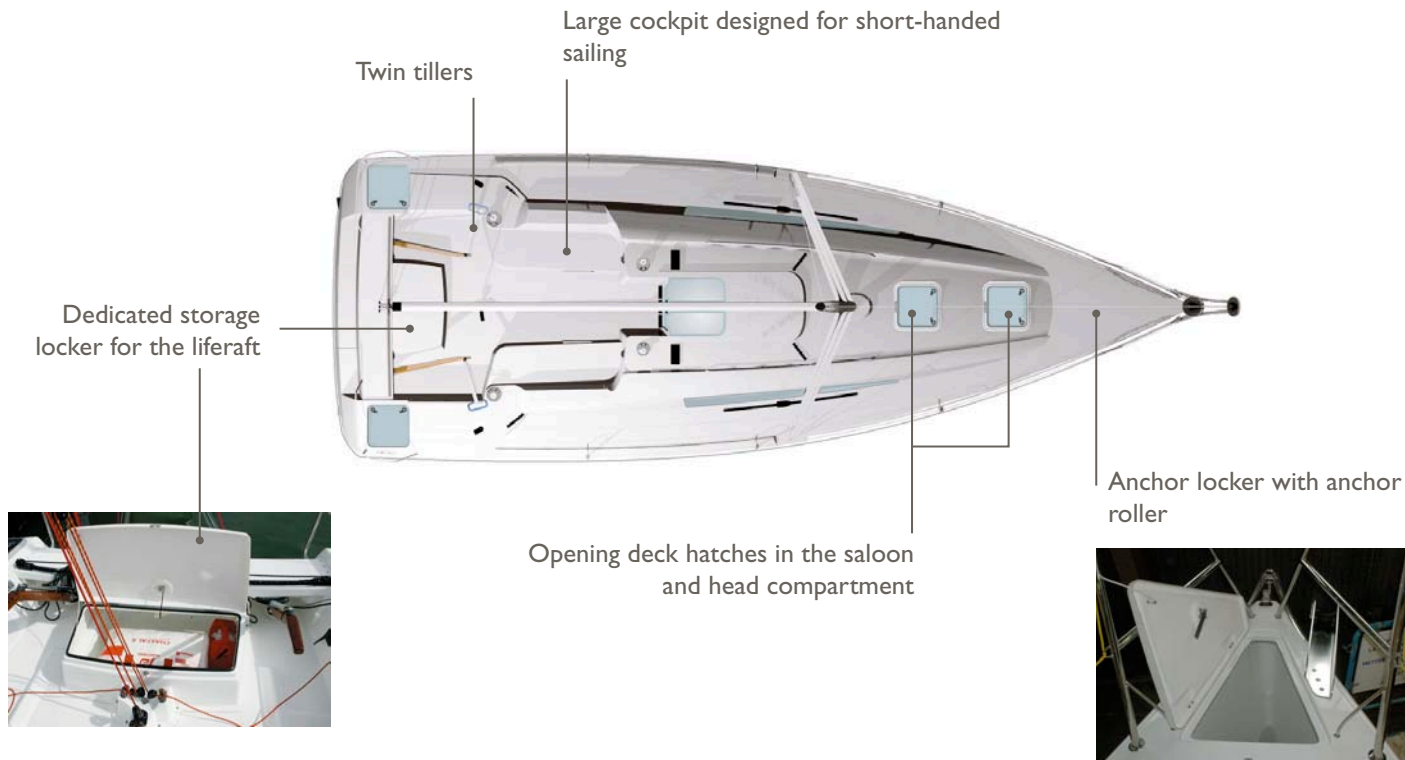

## DECK (continued)

Vacuum bagged deck for precise control of weight and structure

TackTick wireless electronics\* designed for racing



Twin tillers

Harken deck hardware

\* New - Model year 2013

DECK (continued)

Closed transom offers safety offshore but has a platform with a fold-up ladder for easy access to the water

2 water-tight hatches give access to 2 large cockpit lockers

Winches easily accessible from the helm

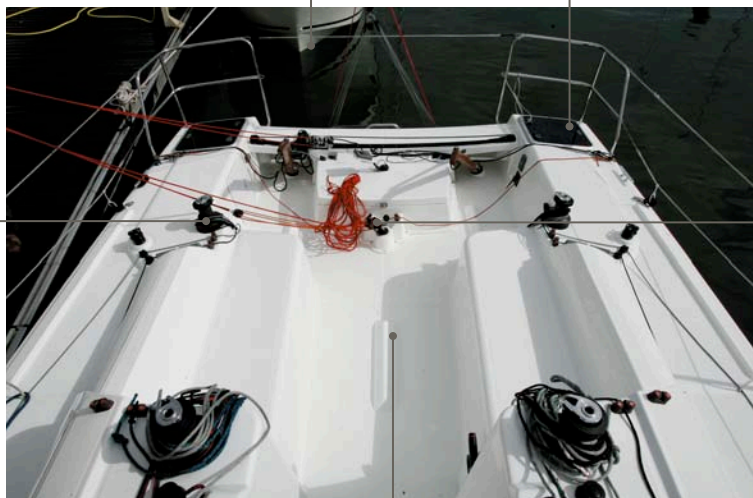

The mainsheet adjustment in front of the helm: the helmsmen does not need to reach behind him to trim the sail



Large cockpit designed for short-handed sailing

## SAIL PLAN

- 1- Mast with 2 sets of swept-back spreaders
- 2- High-aspect rig with a powerful mainsail\*
- 3- Genoa\* with little overlap makes sail handling easy and provides a very balanced sail plan
- 4- Bow sprit designed to take a furling gennaker
- 5- Vacuum bagged hull with a counter moulded structure
- 6- Yanmar 15 HP engine with saildrive and folding propeller
- 7- Twin high-aspect rudders
- 8- L-shaped keel with lead bulb

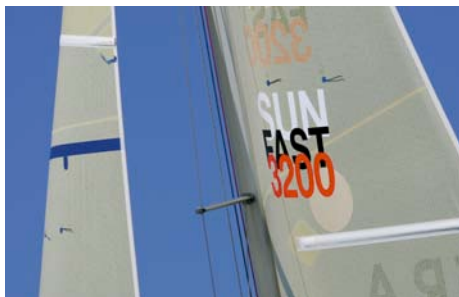

**\*Sails are not included**

## INTERIOR LAYOUT

### 2 cabins version / 1 head



Storage lockers accessible from the deck hatches in the cockpit



## SALOON

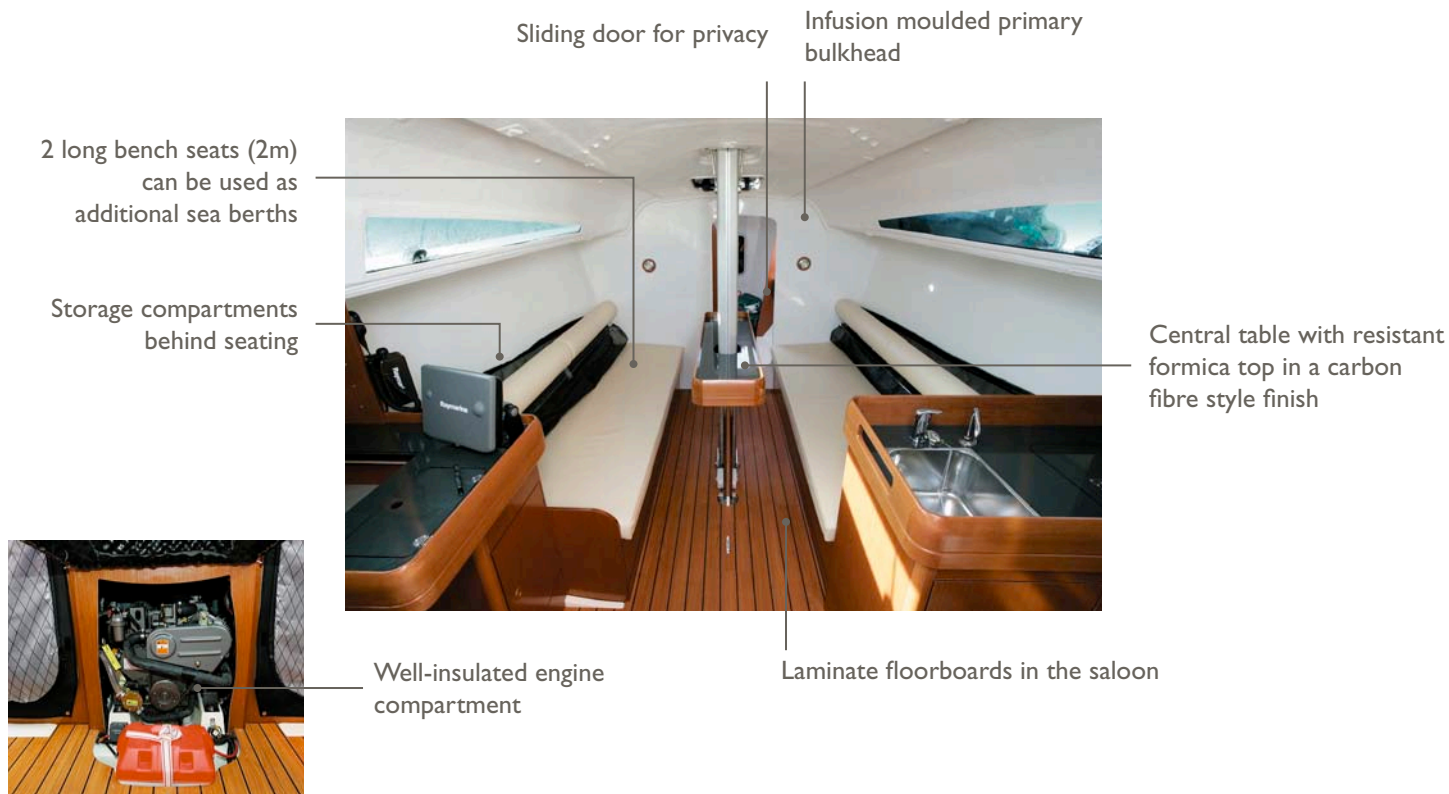

## GALLEY

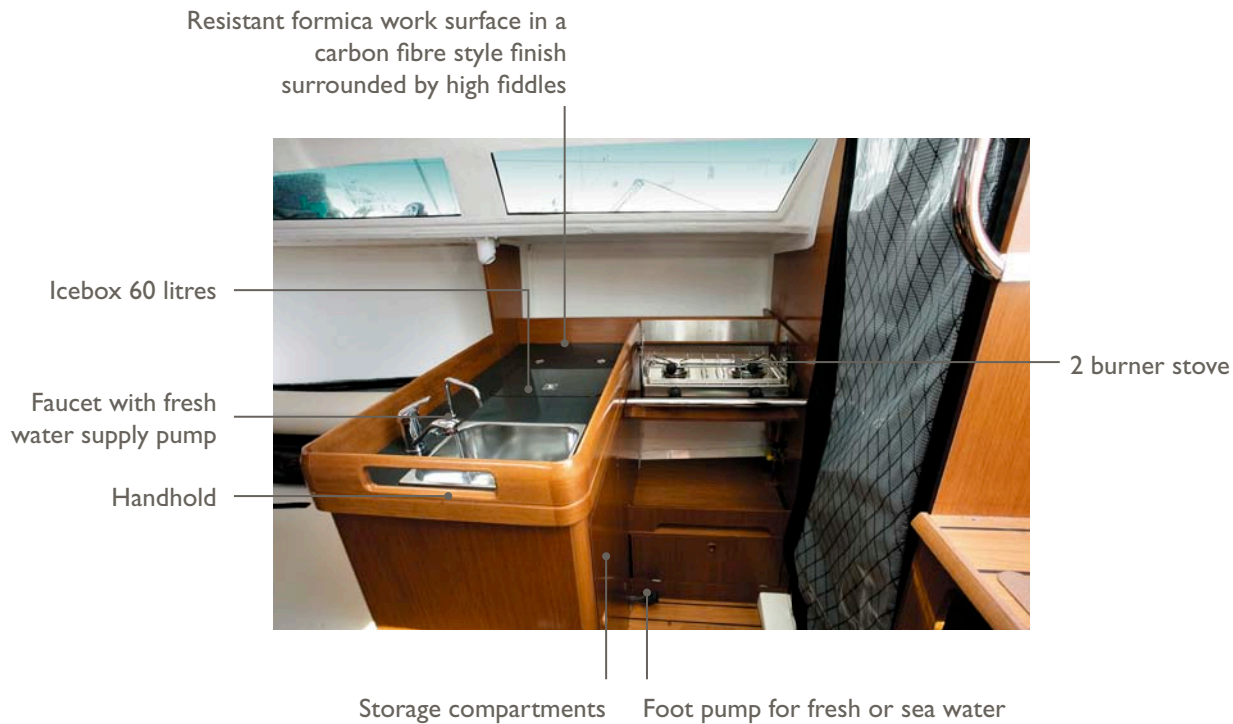

## NAVIGATION DESK

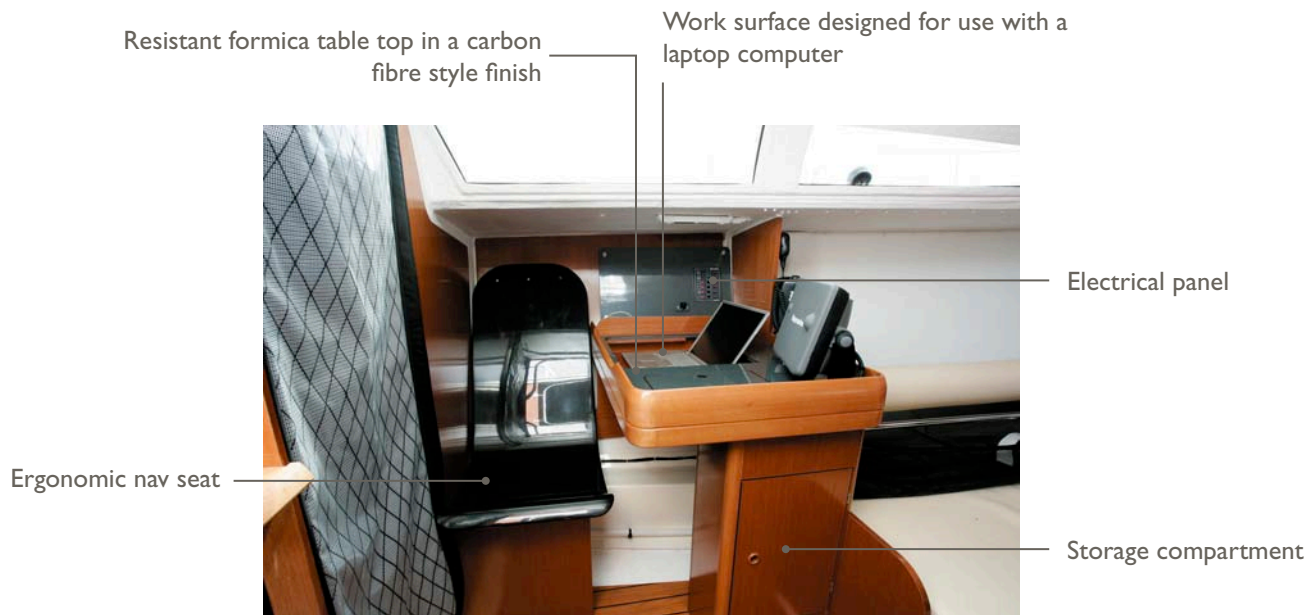

## 2 CABINS DOUBLE

Double berth with  
optional lee clothes for  
comfortable sleeping



Hanging lockers made of fabric  
in each cabin

Fabric doors for privacy  
and weight savings

## HEAD

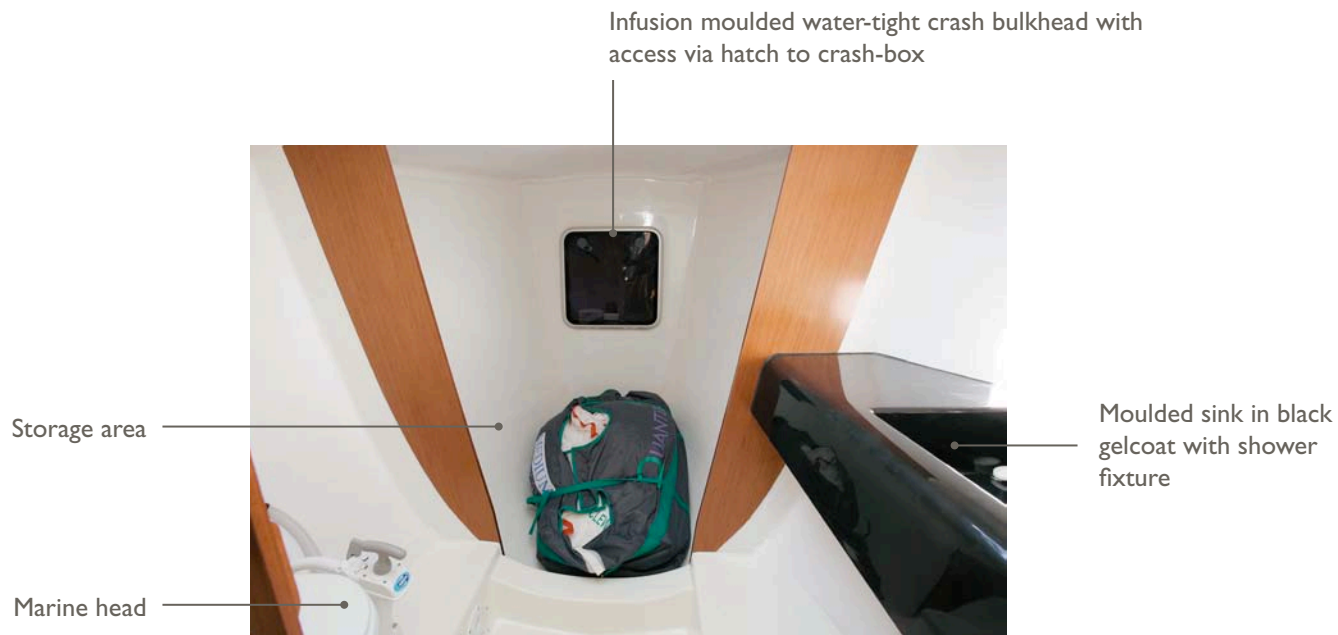



## > 2012

- 1<sup>st</sup> single-handed Barcelona- Menorca-Barcelona (Spain)
- 1<sup>st</sup> - Ar Men Race (France)
- 2<sup>nd</sup> & 3<sup>rd</sup> - France Hatibat Championship (France)
- 2<sup>nd</sup>, 4<sup>th</sup> & 5<sup>th</sup> - Ascension double-handed race (France)
- 1<sup>st</sup> - Saitica - Pornichet - San Vincente de La Barquera - Pornichet (France)
- 2<sup>nd</sup> single and double-handed - Transquadra 2011

## > 2011

- 1<sup>st</sup> - overall Tour of Corsica 2011
- 1<sup>st</sup> - double-handed Transquadra 2011
- 2<sup>nd</sup> - Tour of Finistere 2011
- 2<sup>nd</sup> - Around Great Britain and Ireland Race 2011

## > 2010

- 1<sup>st</sup> Marseille race week - Class 4 - France
- 1<sup>st</sup> week de La Rochelle race week - France
- 1<sup>st</sup> Barquera
- 1<sup>st</sup> Transpertuis

## > 2009

- 2<sup>nd</sup> double-handed Transquadra - France-Martinique 2009
- 1<sup>st</sup> round Corsica all classes - France 2009
- 1<sup>st</sup> Soloduo 2009 - France
- 2<sup>nd</sup> Massilia Lexus Cup IRC - France
- 1<sup>st</sup> Porquerolles race week - France
- 2<sup>nd</sup> Voiles of Saint-Tropez - France

## > 2008

- Winner European Yacht of the Year under 10 metres - Europe
- 1<sup>st</sup> Overall - Simrad OneStar - Norway
- 1<sup>st</sup> & 4<sup>th</sup> Overall - Watski Two Star - Norway/Sweden
- 1<sup>st</sup> Moscow Bank Cup - Russia
- 9<sup>th</sup> Overall IRC - JPMorgan Round the Island Race - UK
- 1<sup>st</sup> Overall - 120 Milles D'Arcachon - France
- 4<sup>th</sup> IRC3 - Spi Ouest France - France
- 2<sup>nd</sup>, 3<sup>rd</sup>, 4<sup>th</sup> & 5<sup>th</sup> Overall - Transquadra Double 1<sup>st</sup> Leg - France-Madera
- 4<sup>th</sup> & 6<sup>th</sup> Overall - Transquadra Solo 1<sup>st</sup> Leg - France-Madera
- 2<sup>nd</sup> & 7<sup>th</sup> Overall - Barquera 2008 - France-Spain

## > 2007

- Winner Innovation Prize - Germany

## INFUSION

The Sun Fast 3200 benefits from the latest advances in resin infusion to ensure exceptional strength and rigidity while drastically reducing weight.

Resin infusion is a process in which every layer of laminate and coring material is placed in a mould dry and then covered with an air-tight plastic bag. A powerful vacuum is then used to pull the resin through the laminate to “wet” it out.

This method eliminates voids in the laminate and ensures that the resin is evenly distributed. Because the amount of resin can be precisely controlled, more precise glass-to-resin ratios can be achieved.

The process is also more environmentally sound, as it greatly reduces VOC emissions released during the moulding process.

Hi-tech Sun Fast 3200 includes:

- Infusion-moulded hull with balsa coring
- Infusion-moulded deck with foam coring
- Infusion-moulded main bulkhead with honeycomb coring

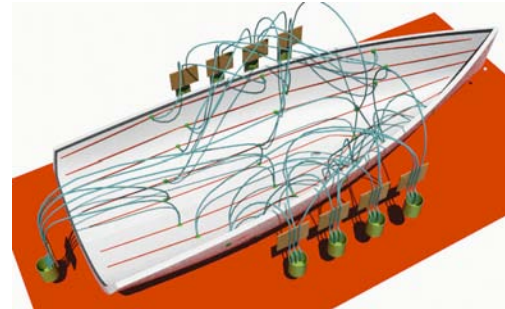
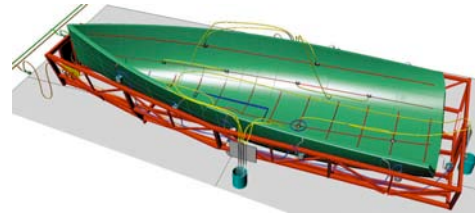

# Raymarine

## Electronic Pack

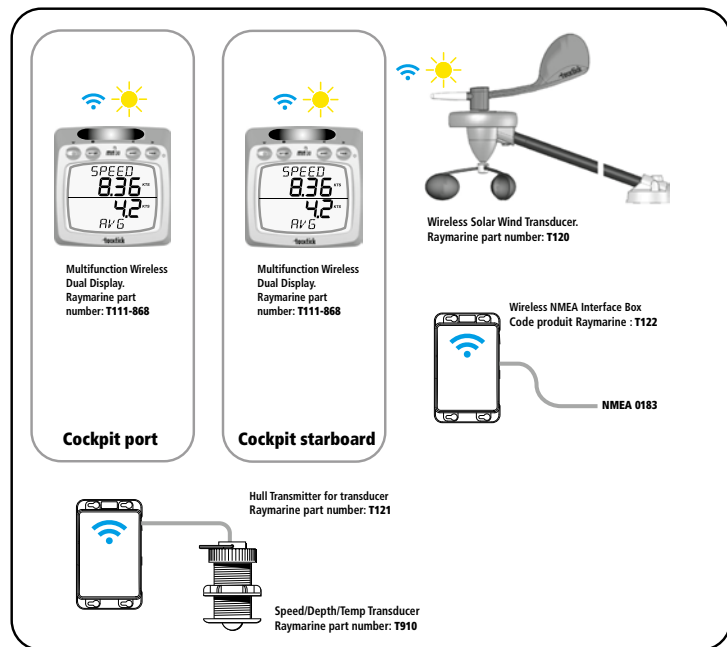

## Mast Maxi repeaters option

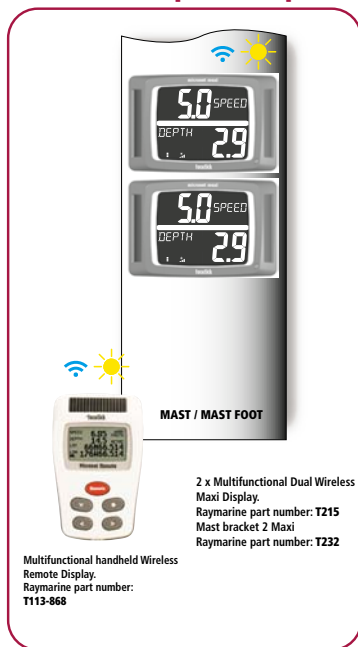

## Autopilot option

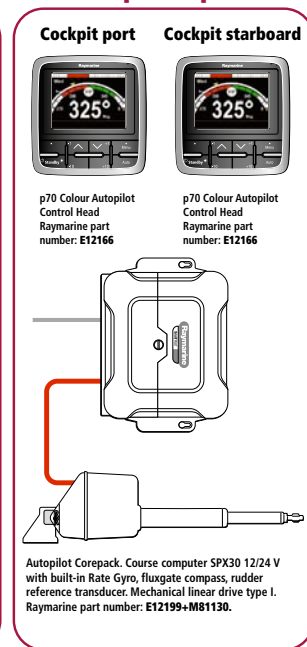



# Raymarine

## OPTIONS

### Chart table

#### e95 Multifunction Touchscreen Display

Touchscreen Multifunction display,  
Navionics Silver supplied  
Raymarine part number: **T70042**



### Fix mounted DSC VHF Radio & Class B AIS transceiver (Works only if a e series screen is fitted)

AIS650 class B AIS transceiver  
Receive and transmit AIS navigation status information  
on e series. Use the VHF antenna.  
Raymarine part number : **E32158**

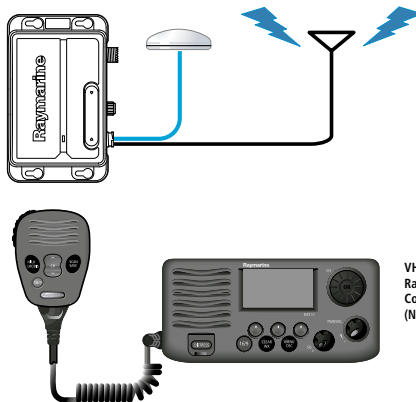

VHF DCS Ray55E  
Raymarine part number : **E43037**  
Compatible with a second station handset  
(Not supplied)

### SmartController Wireless remote



Raymarine part number: **E15023**



July 2012 - Non contractual document