

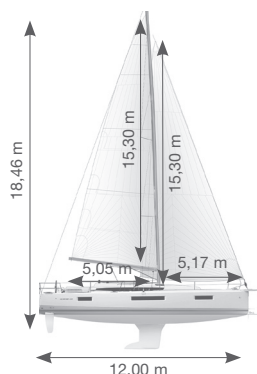

# Sun Odyssey 440

## SPECIFICATIONS

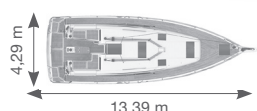

Overall length	<b>13,00 m / 42'7"</b>
Overall Length with Bowsprit	<b>13,39 m / 43'11"</b>
Hull length	<b>12,64 m / 41'5"</b>
Waterline length	<b>12,00 m / 39'4"</b>
Beam	<b>4,29 m / 14'</b>
Displacement light load with deep draft keel	<b>8561 kg / 18874 lbs</b>
Standard keel draft	<b>2,20 m / 7'2"</b>
Standard keel weight	<b>2280 kg / 5027 lbs</b>
Shoal keel draft	<b>1,60 m / 5'2"</b>
Shoal keel weight	<b>2670 kg / 5886 lbs</b>
CE category 2 cabin layout	<b>A6 / B7 / C12</b>

CE category 3 cabin layout	<b>A8 / B9 / C14</b>
CE category 4 cabin layout	<b>A10 / B11 / C16</b>
Fuel capacity	<b>200 L / 53 US gal</b>
Water capacity	<b>330 (+ 200*) L / 87 (+53*) US gal</b>
Fridge capacity	<b>130 L / 34 US gal</b>
Holding tank capacity	<b>100 L / 26 US gal</b>
Architect/Designer	<b>Philippe Briand Piaton Bonet Yacht Design Jeanneau Design</b>
Standard mainsail horizontally-cut in Polyester "High Strength"	<b>45.15 m<sup>2</sup> / 486 Sq ft</b>
Standard 125% headsail horizontally-cut in Polyester "High Strength"	<b>45,15 m<sup>2</sup> / 486 Sq ft</b>

*\*for versions B et C*

## AN EXCEPTIONAL LEVEL OF EQUIPMENT

### EXTERIOR

#### Sailing features

- High aspect ratio rig, cathedral mast and split rigging
- Harken genoa tracks
- Harken roof and primary winches
- Harken deck hardware
- Anodized aluminium mast and boom
- Boom with rigid boom vang and lowered gooseneck, to ease maneuvering
- Battened mainsail. Furling genoa with UV protection
- Discontinuous standing rigging, stainless steel wire
- Lazy bag and lazy jacks
- Sheets lead back to the helm – German sheeting
- Large choice of sails sets and optional performance mast

#### Construction

- Single skin hull, hand-laid fibreglass, ISO gelcoat surface, protective barrier coat
- Infused fiberglass inner liner, easy access to grounding frame, relamination in stays attachment areas
- Prisma Process® injected deck, ISO gelcoat surface, discontinuous balsa block coring – 30% weight savings as compared to traditional decks
- Twin rudders with self-aligning roller bearings

#### Cockpit

- Asymmetrical cockpit with dedicated area for dining, lounging and manoeuvring
- Walk-in access to side decks, enabling to walk around the deck without crossing any steps.
- Multi-function cockpit table
- Leather-covered stainless steel steering wheels
- Large aft fold-down swim platform with telescopic ladder
- Hinged companionway doors

### Deck

- Easy circulation thanks to the inclined side decks
- Flush deck hatches
- Long tinted acrylic roof windows
- Split rigging: Inboard shrouds for easier access forward
- External woodwork and inlays made of teak
- Mid-ship cleats
- Electric windlass

### INTERIOR

- One-level interior with no door sills
- Large doors, double door to access the forward cabin
- Leather-wrapped handrails
- LED lighting
- Large, rectangular double berths
- Fully-upholstered hull sides
- Blinds for each hatch and opening in the forward and aft cabins
- Numerous choices of interior ambiances
- Large seaworthy storage spaces, seaworthy with fiddles. Soft closing drawers and cabinets.
- Shower divider in heads
- Full-size mirrors in the owner's cabin and in the heads

#### Chart table

- Large navigation desk with leatherette lining and interior storage for a portable computer, electrical panel and books storage

#### Galley

- U-shape galley, ideally located near the centre of gravity of the boat
- Corian® countertops

- Double stainless steel sinks
- 2-burner stove with oven
- Fridge 130 L / 34 US gal with front access

#### Woodwork

- Woodwork in alpi® Teak or Grey Cedar
- UV stabilised varnish
- Laminate floorboard in Ceruse Oak colour
- Numerous solid wood mouldings

### TECHNICAL

#### Electrical

- LED navigation and anchoring lights
- 12V electrical panel
- Battery Exide Dual Marine
- 125A alternator and charge distributor/isolator
- Positive and negative battery cut-off switches to better protect battery banks

#### Water System

- Hot and cold cockpit shower
- Hot water heater 40L/ 11US gal
- "Heavy-duty" water pump

#### Engine

- Latest-generation Common Rail engine with reduced emissions and consumption
- Shaft Drive
- Fixed 3-blade propeller
- Sound insulation 40 mm / 1 1/2" thick, with fire retardant film

## TRIM LEVELS AND PACKAGE

TRIM LEVEL	PREMIÈRE	PRÉFÉRENCE
Layout applicable	A, B, C	A, B
GRP bowsprit with integrated anchor roller (replaces the standard anchor roller)	✓	✓
Second windlass control with chain counter, installed in the cockpit	✓	✓
Halyard bags in the cockpit with stainless steel frame (3)	✓	✓
40 amp battery charger for 12V battery banks	✓	✓
Additional service batteries 2 X 115 A/H	✓	✓
LED courtesy lighting in the cockpit	✓	✓
2 burner cooker and oven with grill function (replaces standard 2 burner cooker)	✓	✓
Protective GRP eyebrow for the long acrylic deck windows	✓	✓
Navicolor battery monitoring	✓	✓
Upholstered bulkheads		✓
Indirect led lighting, and lamps on bulkheads		✓
Sound deadening lining in cabinets		✓
Shades for windows and ports in the saloon		✓
Shades and screens for hatches in the saloon		✓
Signature clock and barometer set at the chart table		✓
Wine storage locker under floorboards		✓

### PERFORMANCE VERSION (only for versions A and B)

- Tall anodised mast with 2 spreader, cathedral geometry and split rigging
- Dyform standing rigging
- Performance full batten mainsail, triradial cut, in grey x-grid mylar taffeta 49,22 m² / 530 sq ft
- 125% performance genoa, triradial cut, in grey x-grid mylar taffeta with uv protection 49.15 m²/529 sq ft
- Down wind package
- Harken genoa tracks adjustable from the cockpit
- Dyneema® low-stretch halyards and sheets for main and genoa
- Hydraulic textile adjustable backstay
- Composite steering wheels

### DOWNWIND PACKAGE

- Spinnaker rigging with spinlock jammers
- Halyards and sheet for asymmetrical spinnaker / code 0 (2 polyester halyards, 1 sheet and 1 tack line in Dyneema®, pulleys on mast step and side decks)
- Extra harken 40.2st winch to starboard on coachroof
- Extra winch handle
- windex 15" on mast head

### CONVERTIBLE COCKPIT PACKAGE

- Extending coamings convertible into lounging area
- Cushions for cockpit and sunbathing areas - oyster
- Starboard infill cushion for l-seating area

### EXTERNAL GALLEY PACKAGE

- Safire portable bbq grill in the cockpit
- Cockpit sink with hot & cold water
- Portable 12v fridge in the cockpit table

### PACK VOYAGER (only for versions A and B)

- High transparency sprayhood with led lighting-oyster
- Outboard engine bracket
- Releasable forestay + deck fittings
- Solar panel on coachroof with charging relay
- Seawater / freshwater foot pump in the galley

### PACK ENTERTAINMENT AUDIO

- Ra70n fusion player (radio/usb/bluetooth/...)
- Bose® speakers in the saloon
- Bose® subwoofer
- Speakers in the cockpit

### PACK ENTERTAINMENT VIDEO

- Ms-av750 fusion player (cd/dvd/usb/bluetooth/...)
- Bose® speakers in the saloon
- Bose® subwoofer
- Speakers in the cockpit
- Led tv 22" in the saloon
- Tv antenna for mast fitting

## EQUIPMENT

### ARCHITECTURE

- Full-length chine for improved stability and speed
- Long waterline for better speed while sailing and under power
- L-shaped cast iron keel less exposed to seaweed and lines
- Twin rudders with self-aligning roller bearings

### SAILS

#### Standard

- Horizontally-cut in Polyester "High Strength"
- Semi-battened main sail with 3 reefs 45.15 m² / 486 Sq ft
- 125 %furling genoa with UV protection 45.15 m² / 486 Sq ft

#### Options

- In mast furling main sail horizontally-cut in Polyester "High Strength" 35.48 m² / 382 Sq ft
- Self-tacking jib with UV protection in polyester "High Strength" 30.15 m² / 324 Sq ft
- Code 0 in triradial cut mylar/aramid laminate 81.85 m²/881 Sq ft, with continuous line furler
- Code 0 in triradial cut mylar/aramid laminate for performance mast 88.27 m²/950 Sq ft, with continuous line furler

### SAIL HANDLING

#### Standard

- Mainsheet attached to Dyneema® bridle forward of companionway, with sheets lead back to the cockpit winches
- Harken genoa tracks with adjustable lead cars
- Spinlock jammers
- Coachroof winch 1 x Harken 40.2ST to port
- Genoa winches 2 x Harken 46.2 self-tailing winches for easy use at the helm stations
- Harken winch handle

#### Options

- Self tacking jib ball bearing track on coachroof
- Electrical coachroof winch Harken 40.2ST
- 2 x electrical primary winches Harken 46.2 ST

## MAST AND RIGGING

### Standard

- Classic aluminium mast with double spreaders, deck-stepped, cathedral geometry and split rigging
- Aluminium boom with rigid vang and lowered goose neck for easier handling
- Double backstay
- Genoa furler with double slot, furling line lead aft to cockpit on coach roof
- Running rigging: topping lift, mainsail halyard, genoa halyard, mainsheet, genoa sheets in polyester
- Standing rigging discontinuous 1x19 stainless steel wire
- Asymmetrical lazy bag with integrated lazy jacks

### Option

- Furling mast aluminium with double spreaders, deck-stepped, cathedral geometry and split rigging

## COCKPIT

### Standard

- Walk-in access to side decks, enabling to walk around the deck without crossing any steps.
- Large cockpit table with compass, cup holders, area for navigation instrument, cockpit light switch, LED lighting, bottle storage and optional portable fridge
- Teak inlay on bench seats, helm stations and transom platform
- Fixed coaming with ideal height for comfort and safety
- Cockpit lockers: 1 on starboard side, 1 on port side (version B and C only), 1 large locker on the cockpit floor that can be used for the optional generator, 1 liferaft locker with open access to transom platform 92 x 65 x 48cm (3' x 2'1" x 1'6")
- Universal gas box, cut-off valve under the stove
- Wheels with leather wrap, space for flush mounted GPS at each helm, stainless steel handrail, cup holders
- Emergency tiller, and fitting in cockpit floor
- Engine control: throttle lever at starboard helmstation and oriented engine panel on the cockpit table
- Large bathing platform with telescopic ladder
- Hinged companionway doors in plexiglas
- Sliding horizontal hatch in plexiglas

### Options

- Cockpit table with wooden leaves: replaces the standard table and with all the same functions
- Teak inlay on cockpit floor
- Large cockpit sprayhood, Sunbrella® Oyster, high transparency windscreen and LED cockpit lighting
- Cockpit bimini with stainless steel bows in Sunbrella® Oyster, connecting fabric between bimini and sprayhood
- Cockpit enclosure kit in Sunbrella® Oyster, fitted on the sprayhood and bimini
- Electrical bathing platform system with remote

## DECK HARDWARE

### Standard

- Bow pulpit in stainless steel
- Stern pushpits in stainless steel with buoy bracket and emergency ladder
- Lifelines: double level of stainless steel lifelines
- Mooring cleats: 6 x aluminium
- Stainless steel handrails on coachroof (2)
- Deep anchor locker
- Electric 12V windlass 1000W - 10mm chain
- Long fixed tinted windows along coachroof
- Coachroof windows in the aft cabins (2)
- Large, fixed hull ports (6)
- Opening ports in the roof (4)
- Fixed cockpit windows in the aft cabins (2)
- Opening deck flush hatches (7)
- Opening ports towards cockpit in the aft cabins (1 per cabin)
- Opening ports towards side-deck in the aft cabins (1 per cabin)

### Options

- Folding pulpits seating
- Lifeline gates with removable access ladder
- Teak side-decks
- Rubrail for hull protection
- Mooring kit: 6 fenders and 4 docklines
- Anchoring kit with Delta 20 kg / 44 lbs, 32 m (104') of 10 mm chain and 45 m (147') line
- Sunbed Sunbrella® Oyster on the foredeck

## SAIL LOCKER

### Standard

- Access via lockable deck hatch
- Access ladder in stainless steel

## LIGHTING

### Standard

- Full LED interior lighting

## ELECTRICAL

### Standard

- Main 12V electrical panel at the chart table
- 12V Circuit for house and engine system
- Domestic battery bank capacity 2 x 115 A/H 12V
- Engine start battery capacity 1 x 120 A/H 12V
- 12V engine alternator: 125A
- Positive and negative battery switch 12V in the aft cabin

### Options

- Lithium domestic battery bank 2 x 90 A/H 12V
- USB plug in each cabin
- Inverter 12V > 220V 2000W enable to use 220V appliance from the domestic battery bank
- Generator Onan 7.5KW 230V 2400 rpm, located at the transom

## PLUMBING

### Standard

#### FRESH WATER

- "Heavy-duty" water pump (19 l/5US gal/mn), accumulator tank for consistent water pressure
  - Roto moulded tank: 330 L / 87 US gal, under the aft cabin berth
  - Extra roto moulded tank : 200 L / 53 US gal, under the aft cabin berth, for versions B and C
  - Tank gauges (1 per tank)
  - Tank manifold with selector valves
  - Water boiler 40 L / 11 US gal connected to the engine and 220 V circuit
  - Hot and cold cockpit shower on transom
- #### GREY AND BLACKWATER
- Electrical shower pumps, self-activating
  - Large bowl Marine Toilets
  - Black water tank 50 litres / 13US gal, with gravity drain and deck fitting (1 per head)

#### BILGES DRAINAGE

- Electric bilge pump located in bilge area with activation via switch at electrical panel
- Dual-action manual bilge pump located in the cockpit, with separate hose from primary bilge pump

#### GAS

- Gas leakage detector

### Options

- Electric Quiet-Flush toilets, on fresh water circuit, in place of manual toilets
- Water intake in the cockpit. Enable to connect the fresh water circuit directly to the shore

## ENGINE

### Standard

- Latest-generation Common Rail engine with reduced emissions and consumption
- Yanmar Engine 4JH45CR shaft drive - 45 CV / 33 KW – Alternator 125A
- Engine panel oriented toward helmsman, located on the cockpit table. Throttle at helm station
- Insulation: Foam 40 mm, with fire retardant film
- Built-in muffler, air ventilation and stainless steel exhaust fitting
- Fixed 3 blade propeller
- Ventilation system extractor fan located near the engine, benefiting from the insulation of the engine room. Outlets vents at the back of cockpit
- Roto moulded fuel tank (200 L / 53 US gal) located under the aft cabin berth, fuel / water separator
- Access behind steps to engine compartment and from aft cabins

### Options

- Yanmar Engine 4JH57CR shaft drive - 57 CV / 42KW – Alternator 125A
- Extra fuel tank 200 L / 53 US gal, instead of a fresh water tank underneath the aft cabin berth (available only for versions B and C)
- Retractable bow thruster 4.3kW 85 kgf (187.4 lbs) with a dedicated 12V battery bank
- Flex-o-Fold 3 blade folding propeller



## LAYOUTS

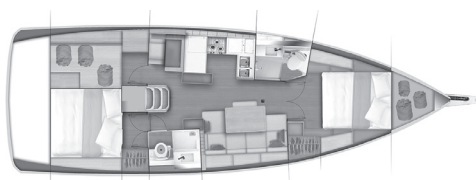

**Version A**  
**Forward Owner's cabin**  
**1 aft cabin / 2 head**

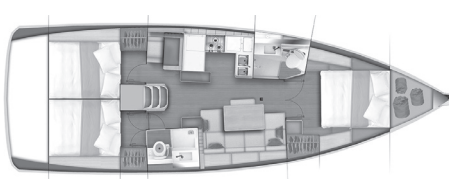

**Version B**  
**Forward master cabin**  
**2 aft cabins / 2 head**

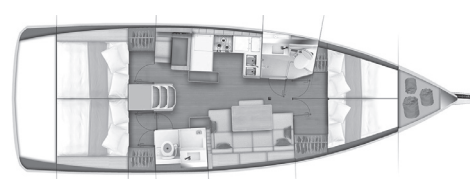

**Version C**  
**2 forward cabins**  
**2 aft cabins / 2 head**

### INTERIOR

#### Woodwork

- Fine Teak® interior woodwork laminated with solid wood trim, UV stabilized varnish
- Fully-upholstered hull sides and ceiling
- Ceruse Oak laminate floorboards

#### Option

- Woodwork in alpi® Grey Cedar mat finish, open-pore varnish

#### Saloon

- Comfortable seating arrangement to starboard with view of sea though hull ports
- Hinged storage compartments under settee
- Large storage between the saloon and the companion way
- Bottles storage
- Large storage behind backrests
- Large table with 2 removable aluminium legs

#### Options

- "Deluxe" folding table on telescopic legs
- Convertible berth in saloon
- Central two-seat bench with storage

#### Chart table

- Large chart table with leatherette worktop opening compartment, for laptop computer
- Book shelf
- Multiple storage for telephone, keys...
- Large storage space under electrical panel for books and other navigation equipment, storage underneath the seat
- Bicolour reading light
- Ergonomic seat, seaworthy

#### Galley

- U-shape galley located on port side, with view on the sea
- Counter top in Corian®, with fiddles
- Double stainless steel sinks with chrome fixtures
- Large drawer in the centre cabinet
- Soft-close, fully-extending drawers
- Waste bin 26L / 7 US gal
- Open storage behind the galley
- 2 burner stove with protective handrail
- Fridge 130 L / 34 US gal with front opening
- Opening hatch above the stove

#### Option

- Push up micro wave

#### Comfort

- Cushions in high-density foam 140mm in the salon
- Premium mattresses

#### Options

- Cruisair® air conditioning working from generator or shore power with 3 units (32000 BTU in total)
- Pushed air heating system 5500W with outlets in each cabin and head (version A)
- Pushed air heating system 7500W with outlets in each cabin and head (versions B and C)

#### Forward Owner's cabin

- Double door
- Large domestic size, rectangular berth, 200 cm x 160 cm / 6'6" x 5'2", with high density premium mattress
- Large hanging locker to starboard with LED lighting
- Lower locker with leatherette top finish
- 2 large drawers underneath the berth.
- Side bed tables with leatherette
- Fully upholstered front bulkhead
- Large mirror in front of the cabin
- LED lighting
- Opening deck hatches, for light and ventilation
- 2 large fixed hull ports with sliding blinds
- Deck hatches with blind and bug screens
- Forward cabin head: En suite compartment with direct access from the cabin, grp sink furniture, storage with towel shelf, teak shelf with fiddle, roof window, large deck hatch, for light and ventilation, indirect LED lighting, shower, shower drain with automatic switch, water inlet valve and connector underneath the sink, large marine toilet with manual pump, hook, large double mirror, shower separated with a plexiglas door

#### Option

- Mattress battens

#### Aft cabins

- Large domestic size, rectangular berth 200 cm x 200 cm / 6'6" x 6'6". with high density premium mattress (Version A)
- Large domestic size, rectangular berth 200 cm x 160 cm / 6'6" x 5'2", with high density premium mattress (Versions B and C)
- Hanging locker storage shelf along hull

- LED Lighting
- LED reading lights
- 1 long fixed hull port, 1 large fixed cockpit window
- 1 opening port on coachroof, 1 opening port towards the cockpit, 1 opening port towards the side decks
- Blinds for each opening
- Access to tanks and technical area behind the engine
- Aft head: double access, from starboard cabin and saloon, grp sink furniture, storage with towel shelf, teak shelf with fiddle, large roof window, opening port for light and ventilation, indirect LED lighting, shower, shower drain with automatic switch, water inlet valve and connector underneath the sink, large marine toilet with manual pump, hook, large mirror, shower separated with a plexiglas door on versions A and B

#### Workshop (version A)

- Workshop located on port side behind the chart table, double access from the interior and the cockpit
- LED lighting
- Large fixed hull window
- Access to the tank
- Direct access to electrical panels
- Lateral storage locker

#### Options

- Washing machine
- Extra fridge 95L / 25 US gal
- Twin forward cabin (version C)
- Berth of 200 cm x 142 cm x 78cm / 6'6" x 4'7" x 2'6", high density premium mattress
- Removable bulkhead between the cabins
- Hanging locker
- Storage underneath the beds
- LED lighting
- Opening deck hatch with ventilation
- Large fixed hull window with sliding blinds
- Blind and bugs screen for deck hatch
- Forward Head : Access from the port side cabin and from the saloon, grp sink furniture, storage with towel shelf, teak shelf with fiddle, roof window, large deck hatch, for light and ventilation, indirect LED lighting, shower, shower drain with automatic switch, water inlet valve and connector underneath the sink, large marine toilet with manual pump, hook, large mirror

## HEADROOM

Forward cabin	1,90 m / 6'2"	Galley	1,95 m / 6'4"
Aft cabin	1,88 m / 6'2"	Forward head	1,90 m / 6'2"
Companionway	1,97 m / 6'5"	Aft head	1,90 m / 6'2"
Saloon	1,97 m / 6'5"		



JEANNEAU

